

# Duct cover VTR 100/150/250/300/500, VTC 200

Installation instructions

GB

Document in original language | 208121 · A005





## 1 Duct cover parts

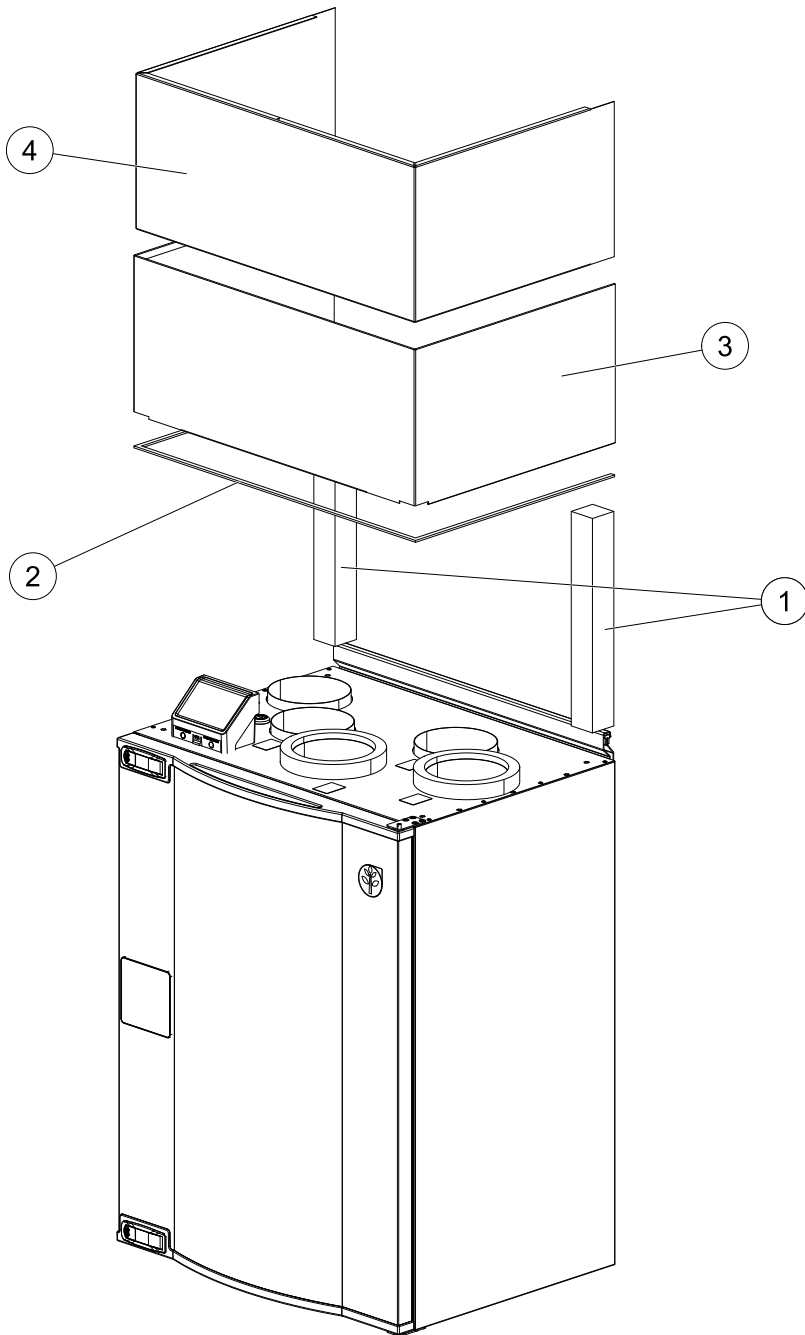

1. Wood stud
2. Cellular rubber strip
3. Duct cover
4. Duct cover, edge 90° bends

## 2 | Duct cover parts

- 1 Attach two wooden studs according to the width of the unit. Save space between the unit and the wooden studs to be able to remove the main unit if necessary. Fasten the rubber strip (pos 2) to prevent structure-borne sound. Fasten duct cover (pos 3) with a screw on each side into the wooden studs. Place the duct cover with the 90° (pos 4) bends inside the mounted duct cover and adjust to desired height between 250-400 mm.  
On VTR 150 the duct cover closest to the main unit has cable glands on each side.

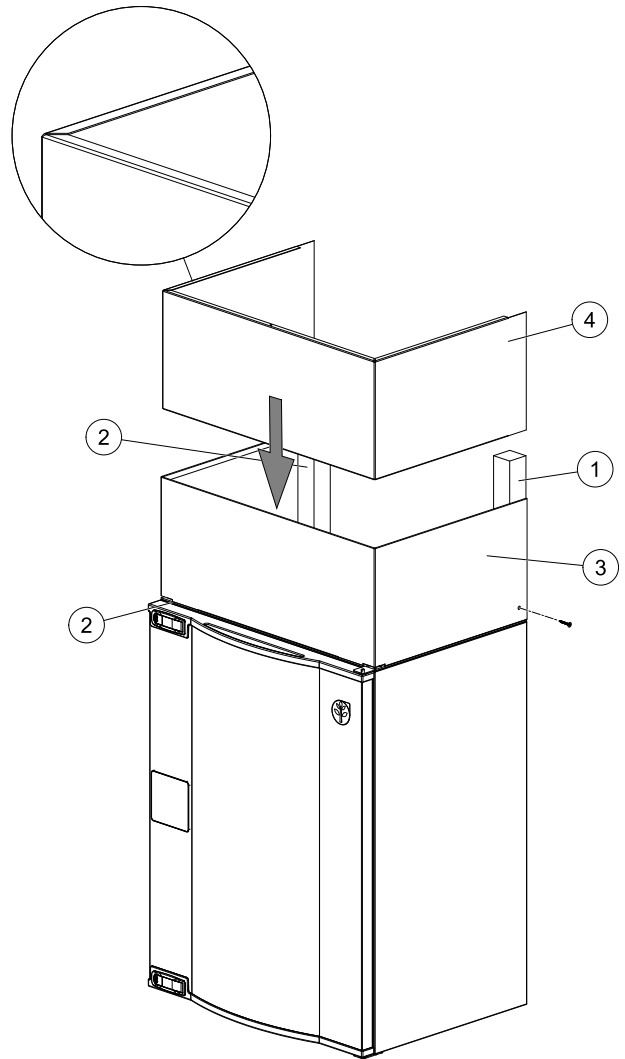

- 2 Fasten the upper duct cover with screws in each side.

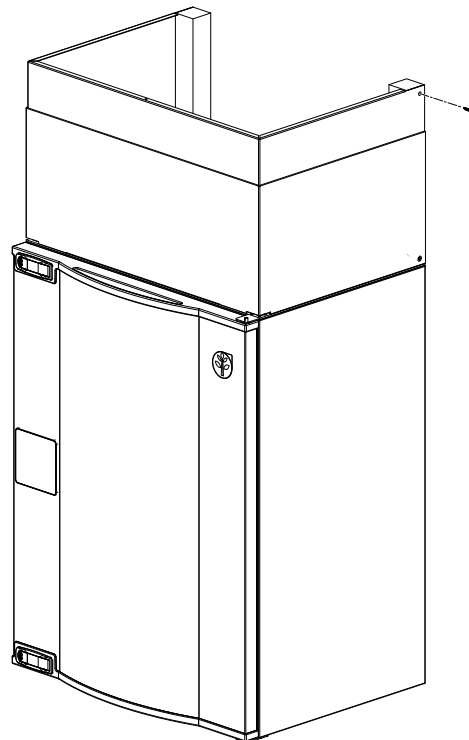





Systemair UAB  
Ling st. 101  
LT-20174 Ukmergė, LITHUANIA

Phone +370 340 60165  
Fax +370 340 60166

[www.systemair.com](http://www.systemair.com)